

Notes:-
 *A check is required to ensure the height & conductivity of the proposed floor insulation meets the current building regulations We have assumed that the floor finish & underlay will not exceed a tog value of 1.50 (R value of 0.15).

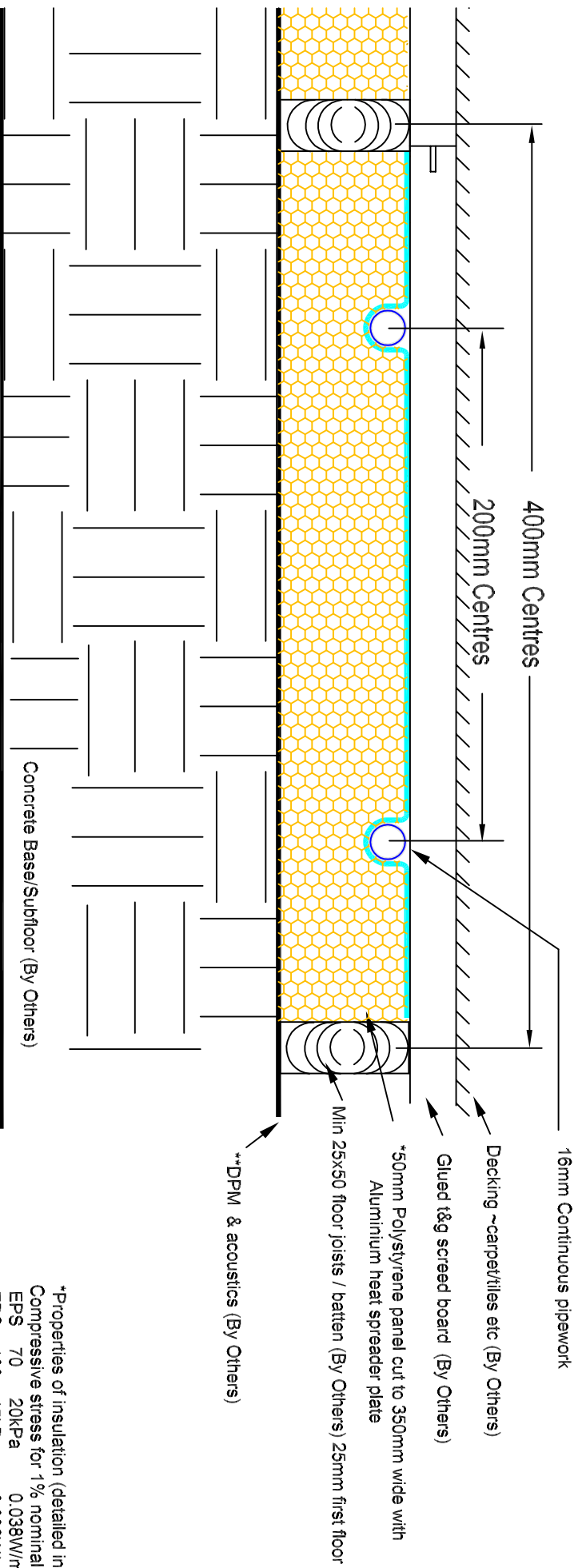

*Properties of insulation (detailed in estimate)
 Compressive stress for 1% nominal strain
 EPS 70 20kPa 0.038W/mk
 EPS 100 45kPa 0.036W/mk
 EPS 150 70kPa 0.035W/mk

U-values
 The thickness of insulation required to meet a given U-value will depend on the size & shape of the floor. Floor perimeter over floor area "P/A".
 The measurement of both the floor area and perimeter should be made on the internal finished surface of the walls enclosing the heated space; unheated areas such as garages, porches and storage spaces need not be included.
 For buildings such as terraces, flats & apartments, the measurement should be taken over the total gross ground-floor area.

CLIENT:	
PROJECT:	

DRAWING TITLE:
 Proposed Ground Floor Construction



2, The Valley, 2nd Floor
 100, The Valley, 2nd Floor
 100, The Valley, 2nd Floor

Date:	26/8	Drawn by:	JK
Scale:	N/S	Approved by:	